

## CLOSED 9-TO-12, HOW TO CONVERT TO 12MM THRU-AXLE

The purpose of this page is to guide you through the steps to convert your Marin bike equipped with a Closed 9-to-12 thru-axle system to a 12mm thru-axle rear wheel. Step-by-step photos on reverse.

MODEL YEARS  
2017 - 2018  
2019 - 2021  
2018 - 2021  
2021

MODELS AFFECTED  
HAWK HILL (BASE)  
HAWK HILL 1  
RIFT ZONE 1  
RIFT ZONE 27.5 1



### PARTS / TOOLS REQUIRED

PN (IF APPLICABLE)	DESCRIPTION
N/A	5mm HEX WRENCH
PARK TOOL FR-5G OR EQUIVALENT	CASSETTE REMOVAL TOOL
PARK TOOL BBT-9 OR EQUIVALENT	CENTER LOCK RING REMOVAL TOOL
PARK TOOL SR-12 OR EQUIVALENT	CHAIN WHIP
N/A	NEW REAR WHEEL WITH THRU-AXLE
SEE INFO ON PARTS PER MODEL	REAR THRU-AXLE

### PARTS PER MODEL

DESCRIPTION	COMPATIBILITY	MARIN ARTICLE CODE
REAR AXLE FOR 142X12MM, THREAD PITCH 1.5	2017/2018 HAWK HILL (BASE)	728551
REPLACEMENT REAR WHEEL WITH 142X12MM THRU-AXLE HUB, CENTER LOCK	2017/2018 HAWK HILL (BASE)	N/A
REAR AXLE FOR 148X12MM, THREAD PITCH 1.5	2019-2021 HAWK HILL 1 / 2017-2021 RIFT ZONE 1 / 2021 RIFT ZONE 27.5 1	728552
REPLACEMENT REAR WHEEL WITH 148X12MM THRU-AXLE HUB, CENTER LOCK	2019-2021 HAWK HILL 1 / 2017-2021 RIFT ZONE 1 / 2021 RIFT ZONE 27.5 1	N/A

### REAR AXLE SPECS

142MM SPACING - 168MM L1, 20MM L2

148MM SPACING - 174MM L1, 20MM L2

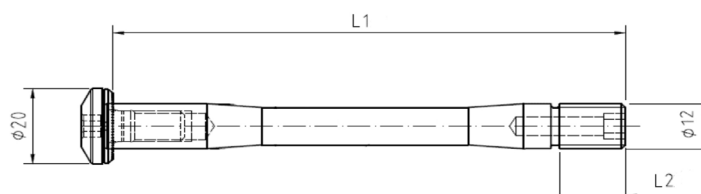

### IDENTIFY 9-to-12 THRU-AXLE SYSTEM

- CLOSED 9-TO-12 THRU-AXLE SYSTEM ON BIKE WITH STOCK 9MM SKEWER. NOTE BLACK DRIVESIDE DROPOUT NUT.
- ABOVE: 20MM THRU-AXLE. BELOW: 9-TO-12 SKEWER, THREADED AXLE ENDS, AND BLACK THREADED DROPOUT NUT.

### STEP BY STEP INSTRUCTIONS

- REMOVE REAR WHEEL FROM BICYCLE.
- REMOVE BLACK NUT FROM DRIVE SIDE OF FRAME USING A 5MM HEX WRENCH.
- REMOVE CASSETTE USING PARK TOOL FR-5G AND SR-12 OR EQUIVALENT AND DISC BRAKE ROTOR USING PARK TOOL BBT-9 OR EQUIVALENT (SKIP IF YOU HAVE NEW CASSETTE AND ROTOR).
- INSTALL CASSETTE USING PARK TOOL FR-5G AND SR-12 OR EQUIVALENT AND DISC BRAKE ROTOR USING PARK TOOL BBT-9 ON NEW WHEEL. TORQUE CASSETTE AND ROTOR TO MANUFACTURER'S SPECIFICATIONS.
- INSTALL 12MM THRU-AXLE REAR WHEEL IN BIKE WITH CORRECT MARIN THRU-AXLE (SEE PARTS PER MODEL) AND TORQUE TO 12 NM (106 IN-LB.).
- ADJUST REAR DISC BRAKE USING 5MM HEX WRENCH PER MANUFACTURER'S SPECIFICATION TO ENSURE DISC CALIPER IS CENTERED ON ROTOR AND WORKING PROPERLY.
- ADJUST REAR DERAILLEUR LIMIT SCREWS PER MANUFACTURER'S SPECIFICATION TO ENSURE UPPER AND LOWER LIMITS ARE SET CORRECTLY.
- DOUBLE CHECK SHIFTING AND BRAKING BEFORE RIDING. BE SURE TO DOUBLE CHECK THE REAR DERAILLEUR LIMIT SCREWS.

## CLOSED 9-TO-12. HOW TO CONVERT TO 12MM THRU-AXLE



### IDENTIFY 9-to-12 THRU-AXLE SYSTEM

1. CLOSED 9-TO-12 THRU-AXLE SYSTEM ON BIKE WITH STOCK 9MM SKEWER. NOTE BLACK DRIVESIDE DROPOUT NUT.
2. ABOVE: 12MM THRU-AXLE. BELOW: 9-TO-12 SKEWER, THREADED AXLE ENDS, AND BLACK THREADED DROPOUT NUT.



STEPS 1-2 - REMOVE REAR WHEEL

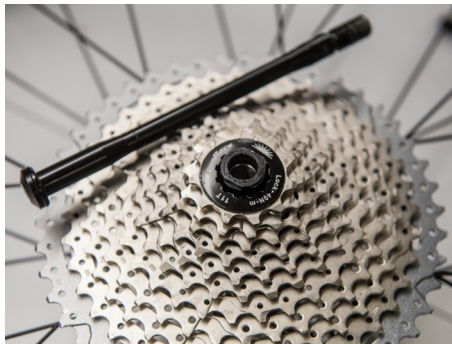

STEP 3 - REMOVE CASSETTE

STEP 4 - INSTALL CASSETTE

STEP 5 - INSTALL THRU-AXLE