

SHIMANO 105 Caliper Brake BR-5810-R For Rear

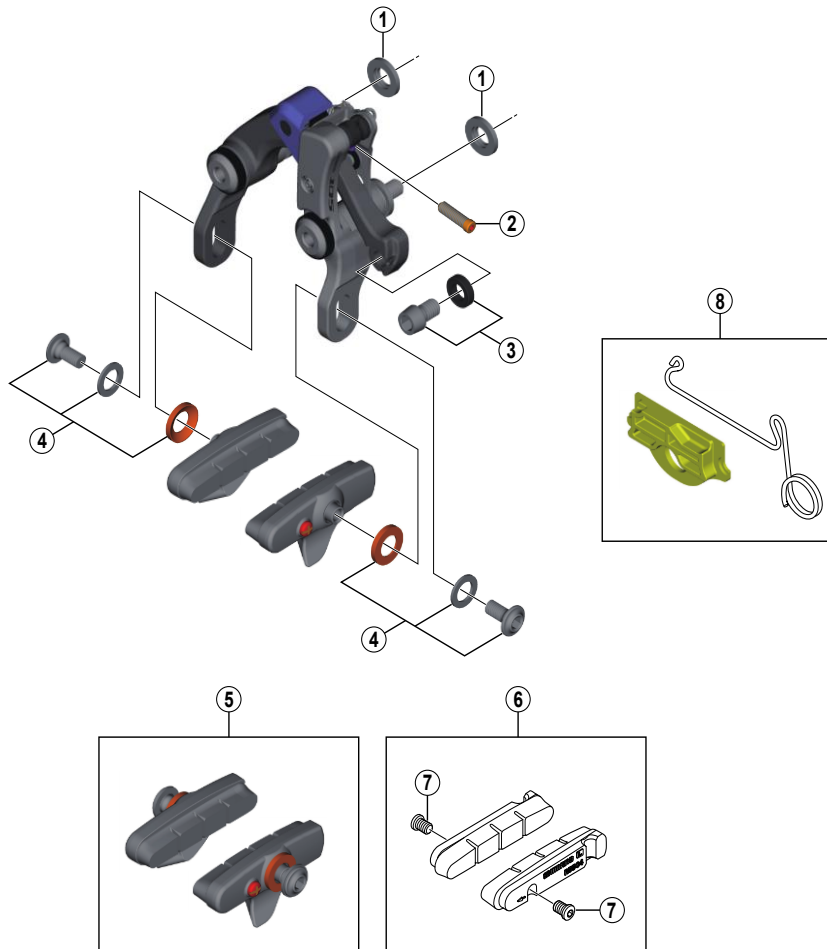

ITEM NO.	SHIMANO CODE NO.	DESCRIPTION	INTERCHANGEABILITY	
			BR-5710	BR-6810
1	Y8LK11000	Adapter	A	
2	Y6AM82400	Centering Adjustment Bolt (M4 x 13.5)	A	A
3	Y88V98010	Cable Fixing Bolt (M6 x 8.5) & Plate		
4	Y8G698090	Shoe Fixing Bolt Unit (M5 x 11.2)	A	A
5	Y8LJ98010	R55C4 Cartridge-Type Brake Shoe Set (Pair)	B	B
6	Y8L298060	R55C4 Cartridge-Type Brake Shoes & Fixing Bolts (Pair)	A	B
	Y8L298070	R55C4 Cartridge-Type Brake Shoes & Fixing Bolts (Pair) for Carbon Rim	A	B
	Y8L398030	R55C4-1 Cartridge-Type Brake Shoes (-1 mm thinner shoe) & Fixing Bolts (Pair) for Carbon Rim	A	B
7	Y8L227000	Fixing Bolt (M4 x 5.5)	A	B
8	Y8L398040	Assembly Jig	A	A

A: Same parts.

B: Parts are usable, but differ in materials, appearance, finish, size, etc.

Absence of mark indicates non-interchangeability.

Apr.-2014-3718
© Shimano Inc. H

Specifications are subject to change without notice.

SHIMANO