

Cassette Sprocket (9-speed)  
**CS-HG200-9** bo/bn/bw-Group

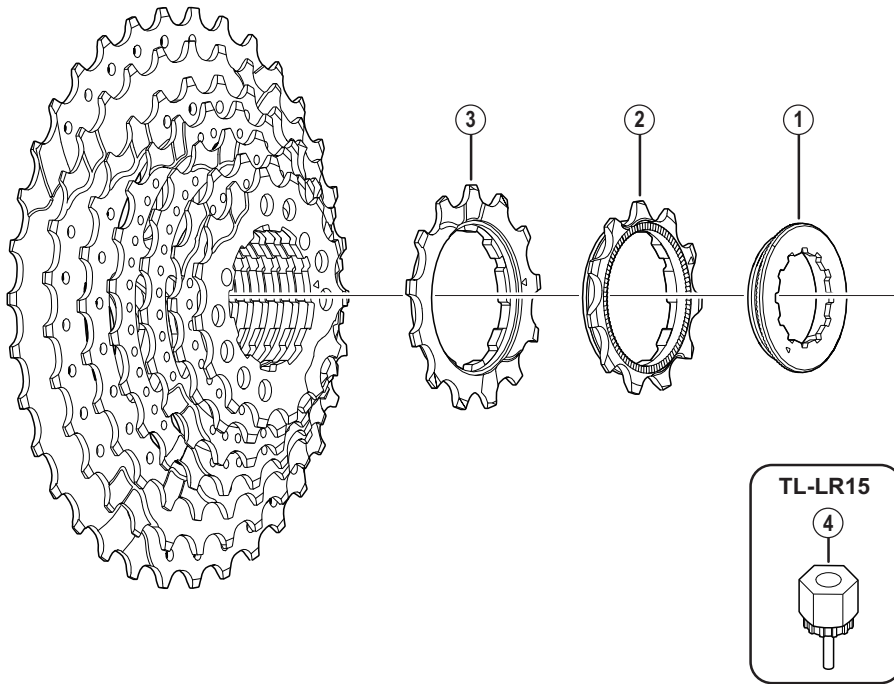

- **bo-group sprocket teeth combination: 11-13-15-17-19-21-24-28-32T**
- **bn-group sprocket teeth combination: 11-13-15-17-20-23-26-30-34T**
- **bw-group sprocket teeth combination: 11-13-15-17-20-23-26-30-36T**

CS-HG200-9

ITEM NO.	SHIMANO CODE NO.	DESCRIPTION	INTERCHANGEABILITY
1	Y1Y708000	Lock Ring	B
2	Y1Y711000	Sprocket Wheel 11T (Built in spacer type)	B
3	Y1Y713000	Sprocket Wheel 13T (Built in spacer type)	B
4	Y12009230	Lock Ring Removal Tool (TL-LR15)	A

A: Same parts.

B: Parts are usable, but differ in materials, appearance, finish, size, etc.

Absence of mark indicates non-interchangeability.

Specifications are subject to change without notice.

Feb.-2017-3704A

© Shimano Inc. I

**SHIMANO**