

Front Chainwheel FC-M371

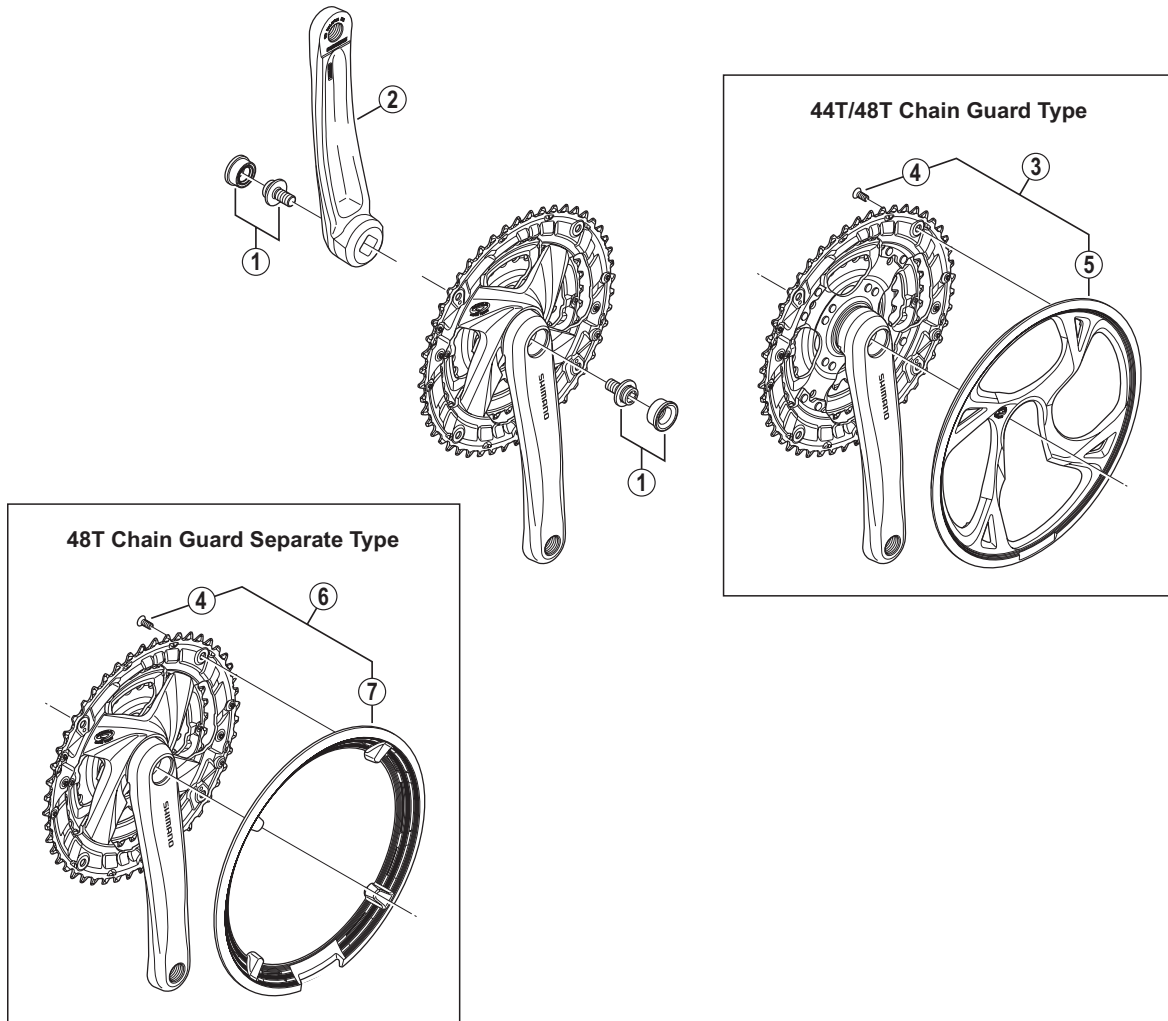

• Chaining teeth combinations: 44-32-22T / 48-36-26T

| ITEM NO. | SHIMANO CODE NO. | DESCRIPTION | INTERCHANGEABILITY |
|----------|------------------|--|--------------------|
| 1 | Y1NK98010 | Crank Arm Fixing Bolt & Cap | |
| 2 | Y1NK98020 | Left Hand Crank Arm 165 mm (Silver) | |
| | Y1NK98030 | Left Hand Crank Arm 165 mm (Black) | |
| | Y1NK98040 | Left Hand Crank Arm 170 mm (Silver) | |
| | Y1NK98050 | Left Hand Crank Arm 170 mm (Black) | |
| | Y1NK98060 | Left Hand Crank Arm 175 mm (Silver) | |
| | Y1NK98070 | Left Hand Crank Arm 175 mm (Black) | |
| 3 | Y1NK98080 | 44T Chain Guard & Fixing Bolts | |
| | Y1NK98090 | 48T Chain Guard & Fixing Bolts | |
| 4 | Y1D298010 | Chain Guard Fixing Bolt (4 pcs.) | |
| 5 | Y1NK12000 | 44T Chain Guard | |
| | Y1NK12010 | 48T Chain Guard | |
| 6 | Y1M298160 | 48T Chain Guard Separate Type & Fixing Bolts | |
| 7 | Y1LD12100 | 48T Chain Guard Separate Type | |

A: Same parts.

B: Parts are usable, but differ in materials, appearance, finish, size, etc.

Absence of mark indicates non-interchangeability.

Jun.-2012-3362

© Shimano Inc. I