

GRX Crankset
FC-RX600
BB-RS500

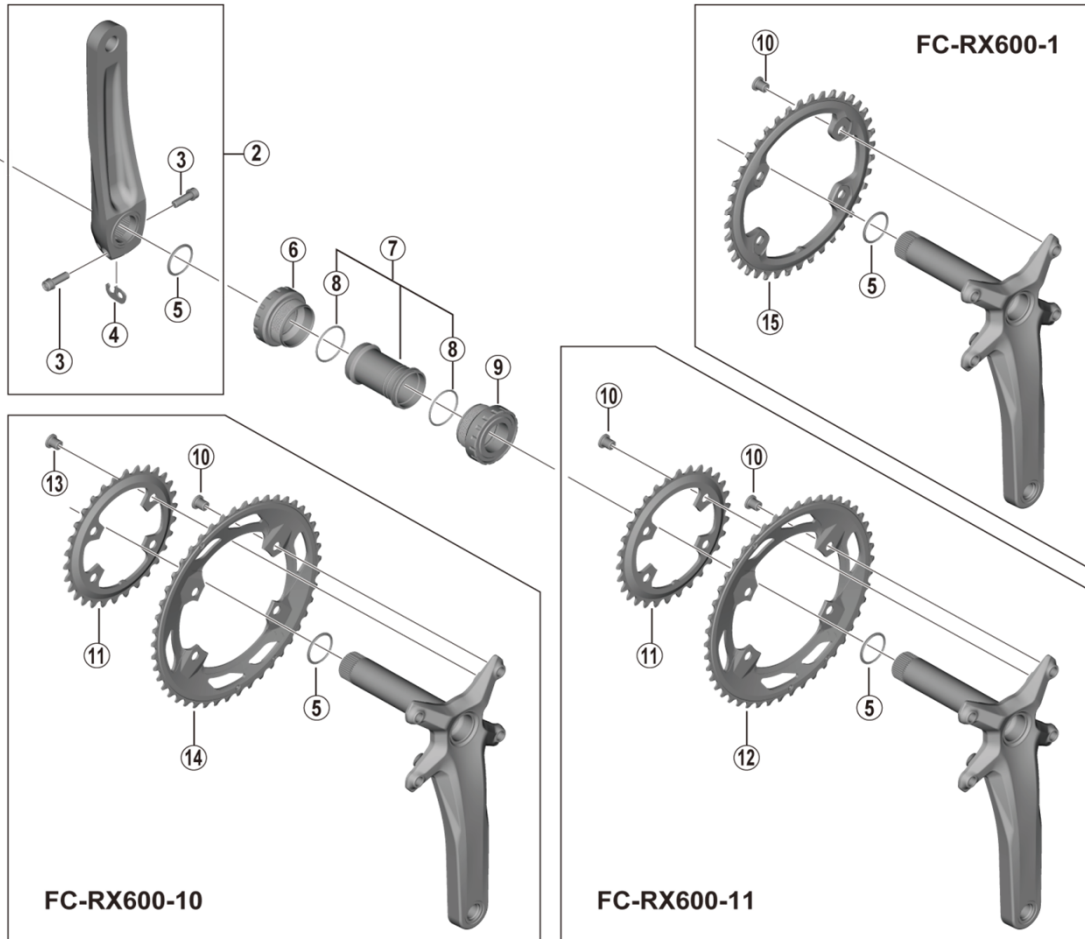

- Chaining teeth combinations: 46-30T / 40T
- Bolt circle diameter: 110 mm...(For outer gear), 80 mm...(For inner gear)

ITEM NO.	SHIMANO CODE NO.	DESCRIPTION
1	Y1F811100	Crank Arm Fixing Bolt
2	Y0K698020	Left Hand Crank Arm Unit 170 mm
	Y0K698030	Left Hand Crank Arm Unit 172.5 mm
	Y0K698040	Left Hand Crank Arm Unit 175 mm
3	Y1GS00030	Clamp Bolt with Washer (M6 x 19)
4	Y1GE98050	Plate
5	Y1F316000	Ring
6	Y1RF98010	Left Hand Adapter (B.C.1.37" x 24T) English Thread (BB-RS500)
	Y1RF98020	Left Hand Adapter (M36 x 24T) Italian Thread (BB-RS500)
7	Y1RF98050	Inner Cover & O-Ring
8	Y1TF21000	O-Ring
9	Y1RF98030	Right Hand Adapter (B.C.1.37" x 24T) English Thread (BB-RS500)
	Y1RF98040	Right Hand Adapter (M36 x 24T) Italian Thread (BB-RS500)
10	Y1WD98050	Gear Fixing Bolt (M8 x 8.5 / 1 Unit = 4 pcs.)
11	Y0K630000	Chaining 30T-NF
12	Y0K698010	Chaining 46T-NF
13	Y1LV98060	Inner Gear Fixing Bolt (M8 x 8.5 / 1 Unit = 4 pcs.)
14	Y0K798010	Chaining 46T-NF
15	Y0K540000	Chaining 40T

Jun.-2019-4579
 © Shimano Inc. I

Specifications are subject to change without notice.

SHIMANO