

DEORE Front Hub (For Disc Brake)

# HB-M6010 HB-M6010-B

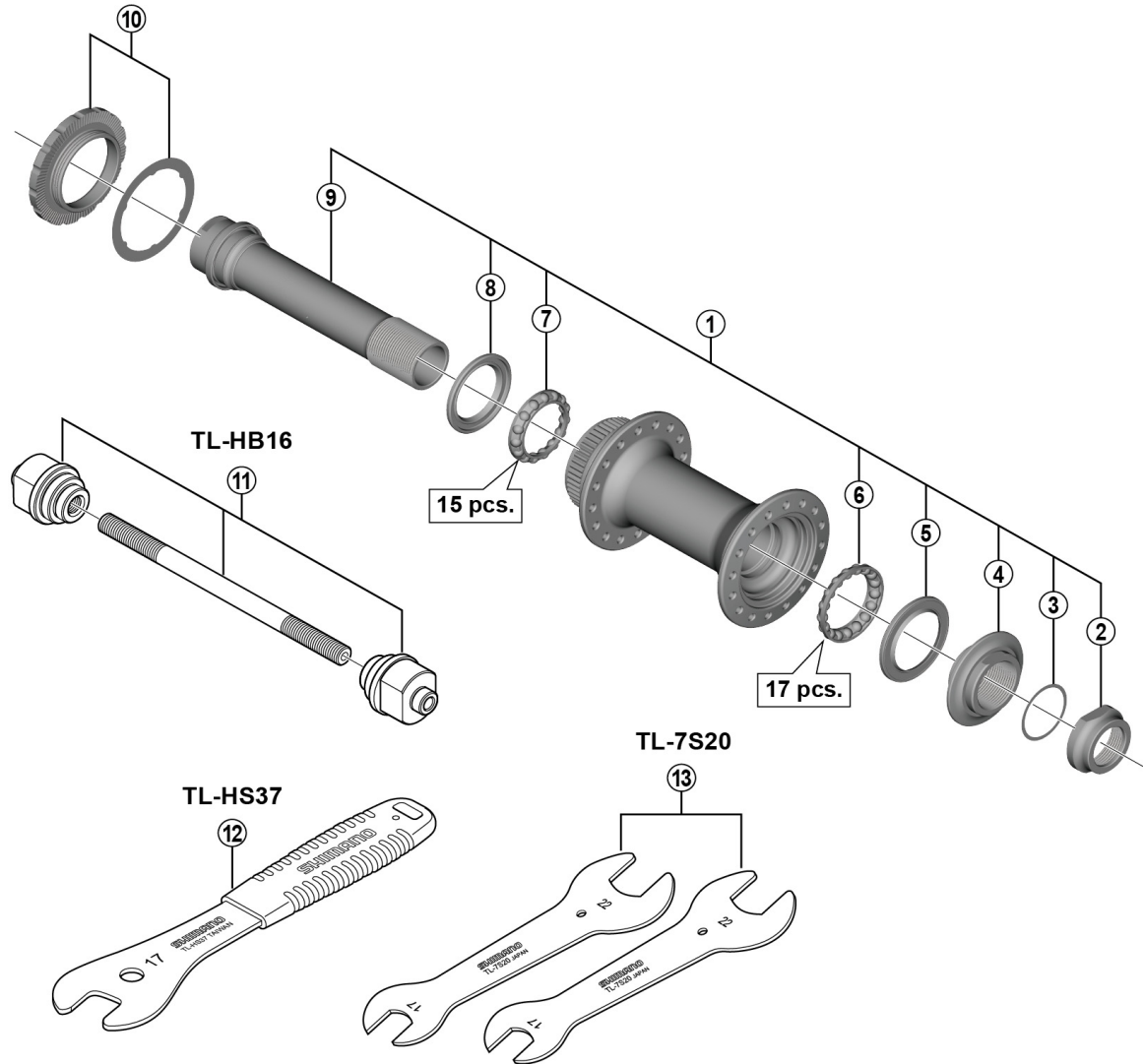

• Over Lock Nut Dimension: 100 mm (3-15/16") for HB-M6010 / 110 mm (4-11/32") for HB-M6010-B

HB-M618

ITEM NO.	SHIMANO CODE NO.	DESCRIPTION	INTERCHANGEABILITY	
1	Y24698010	Complete Hub Axle for HB-M6010	A	
	Y2AJ98010	Complete Hub Axle for HB-M6010-B	A	
2	Y24612000	Right Hand Lock Nut	A	
3	Y24613000	Adjusting Washer	A	
4	Y24698040	Right Hand Cone w/Dust Cap	A	
5	Y27X15000	Right Hand Seal Ring	A	
6	Y27X98030	Right Hand Ball Retainer (5/32" x 17)	A	
7	Y27X98040	Left Hand Ball Retainer (5/32" x 15)	A	
8	Y27X14000	Left Hand Seal Ring	A	
9	Y24698020	Hub Axle Unit for HB-M6010	A	
	Y2AJ98020	Hub Axle Unit for HB-M6010-B	A	
10	Y24698030	Lock Ring & Washer	A	
11	Y20W98020	TL-HB16 Hub Setting Tool	A	
12	Y23098030	TL-HS37 Hub Spanner (17 mm)	A	
13	Y13098900	TL-7S20 Hub Spanner (17 mm x 22 mm) 2 pcs.	A	

A: Same parts.

B: Parts are usable, but differ in materials, appearance, finish, size, etc.

Absence of mark indicates non-interchangeability.

Specifications are subject to change without notice.

Mar.-2017-4194

© Shimano Inc. I

# SHIMANO