

# Tourney TX Front Hub HB-TX800

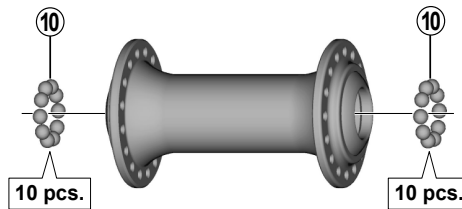
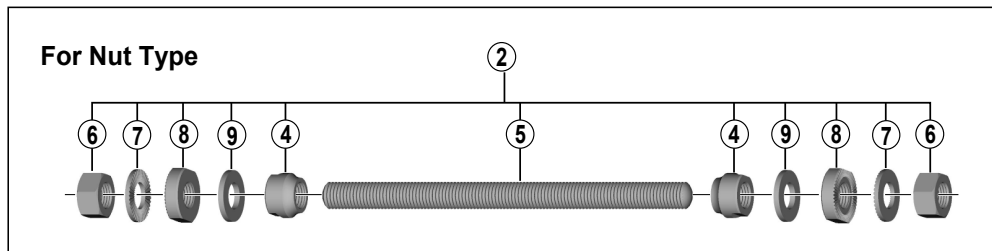
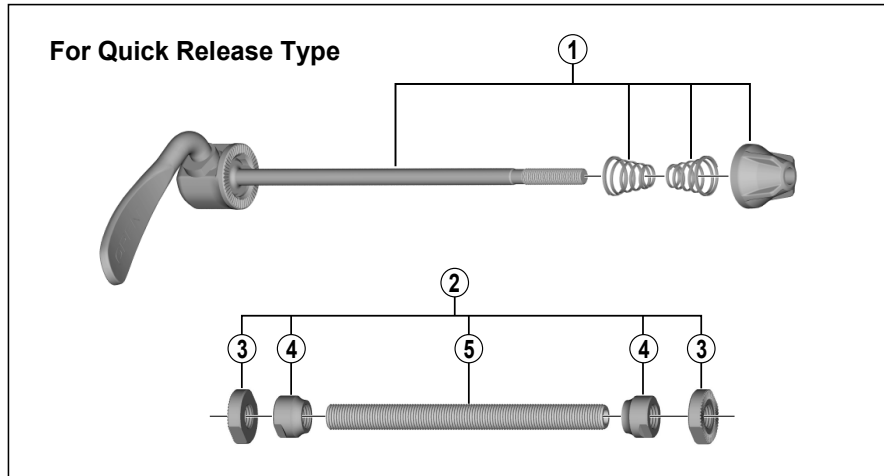

• Over Lock Nut Dimension: 100 mm (3-15/16")

ITEM NO.	SHIMANO CODE NO.	DESCRIPTION
*	<b>Y2AU98010</b>	Complete Quick Release 129 mm (5-3/32") Silver
*	<b>Y2AU98020</b>	Complete Quick Release 129 mm (5-3/32") Black
* 1	<b>Y2AU98030</b>	Complete Quick Release 133 mm (5-1/4") Silver
*	<b>Y2A398010</b>	Complete Quick Release 133 mm (5-1/4") Black
2	<b>Y29E98050</b>	Complete Hub Axle 108 mm (4-1/4") for Quick Release Type
	<b>Y29E98060</b>	Complete Hub Axle 140 mm (5-1/2") for Nut Type
3	<b>Y21H08000</b>	Serrated Lock Nut 3 mm for Quick Release Type
4	<b>Y23104000</b>	Cone M9 x 10.4 mm
5	<b>Y21C03100</b>	Hub Axle 108 mm (4-1/4") for Quick Release Type
	<b>Y21D05200</b>	Hub Axle 140 mm (5-1/2") for Nut Type
6	<b>Y21D02000</b>	Fixing Nut
7	<b>Y21D03000</b>	Rollet Washer 2 mm
8	<b>Y21D04010</b>	Lock Nut 3 mm for Nut Type
9	<b>Y21H10200</b>	Washer (2 mm)
10	<b>Y00091210</b>	Steel Ball (3/16") 20 pcs.

May-2016-3752B  
© Shimano Inc. I

Specifications are subject to change without notice.

# SHIMANO