

# Seat Post Lever SL-MT800-IL I-spec EV

For Left Hand

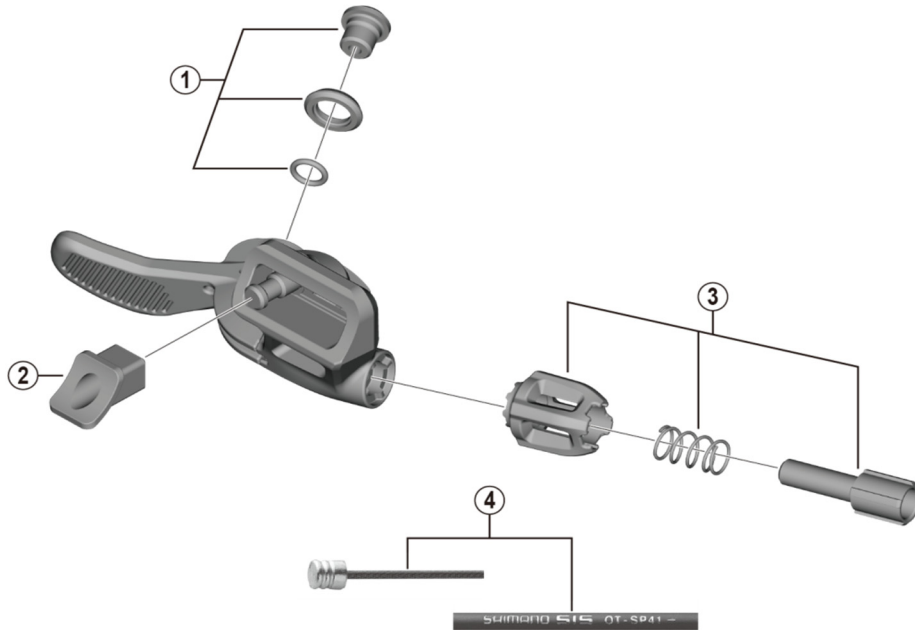

ITEM NO.	SHIMANO CODE NO.	DESCRIPTION
1	Y0FC98010	Cable Fixing Bolt Unit
2	Y0FB50000	Integration Nut
3	Y06N98040	Cable Adjusting Bolt Unit
4	Y01V98110	OT-SP41 Polymer coated shift cable sets (Black) <ul style="list-style-type: none"> <li>• Sealed outer caps, plastic (2 pcs.)</li> <li>• Sealed outer caps, aluminum (2 pcs.)</li> <li>• Sealed outer caps nose (7 pcs.)</li> <li>• Rubber shields (7 pcs.)</li> <li>• Inner end caps (2 pcs.)</li> <li>• Cover with tongue for front / rear derailleur (2 pcs.)</li> </ul>
	Y01V98111	OT-SP41 Polymer coated shift cable sets (White) <ul style="list-style-type: none"> <li>• Sealed outer caps, plastic (2 pcs.)</li> <li>• Sealed outer caps, aluminum (2 pcs.)</li> <li>• Sealed outer caps nose (7 pcs.)</li> <li>• Rubber shields (7 pcs.)</li> <li>• Inner end caps (2 pcs.)</li> <li>• Cover with tongue for front / rear derailleur (2 pcs.)</li> </ul>

Jun.-2018-4364

© Shimano Inc. I

Specifications are subject to change without notice.

# SHIMANO