

DURA-ACE Dual Control Lever

ST-R9150 (2x11-speed)

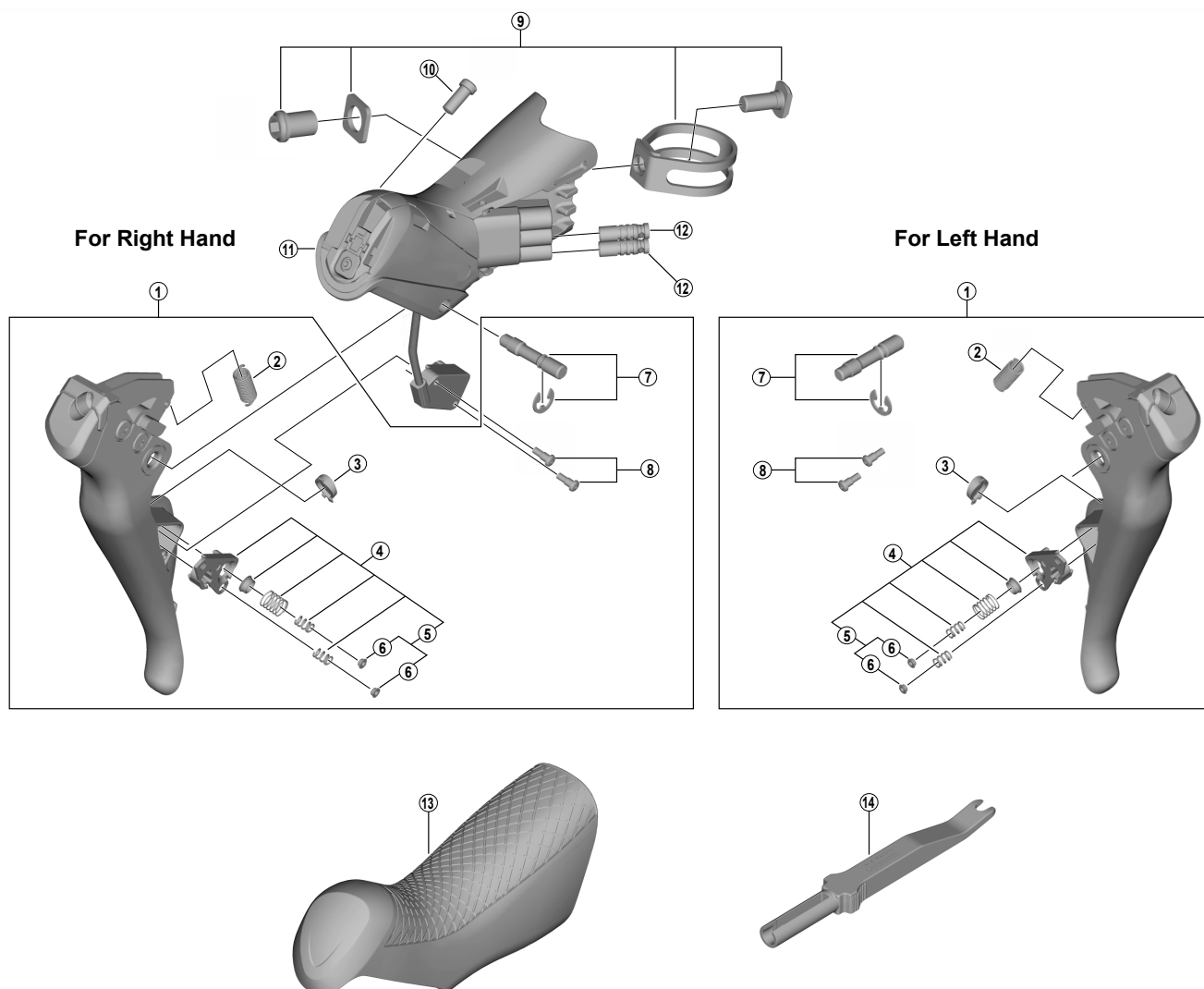

ITEM NO.	SHIMANO CODE NO.	DESCRIPTION
1	Y0C898020	R.H. Main Lever Assembly
	Y0C798010	L.H. Main Lever Assembly
2	Y0C800043	Return Spring
3	Y0C800009	SW Axle Cap
4	Y0C898090	R.H. SW Button Unit
	Y0C798030	L.H. SW Button Unit
5	Y0C898040	SW Button (2 pcs.)
6	Y0C800024	SW Button
7	Y0C898050	Lever Axle & E-Ring
8	Y0C898060	Switch Unit Fixing Screw (2 pcs.)
9	Y0C898070	Clamp Band Unit (ø23.8 mm - ø24.2 mm)
10	Y0C800012	Grip Adjusting Screw
11	Y0C898080	R.H. Bracket Unit
	Y0C798020	L.H. Bracket Unit
12	Y6VE15000	Dummy Plug
13	Y0C898010	Bracket Covers (Pair)
14	Y6VE16000	TL-EW02 Plug Tool

Jul.-2017-4062
© Shimano Inc. I

Specifications are subject to change without notice.

SHIMANO