

Pedals PD-GR500

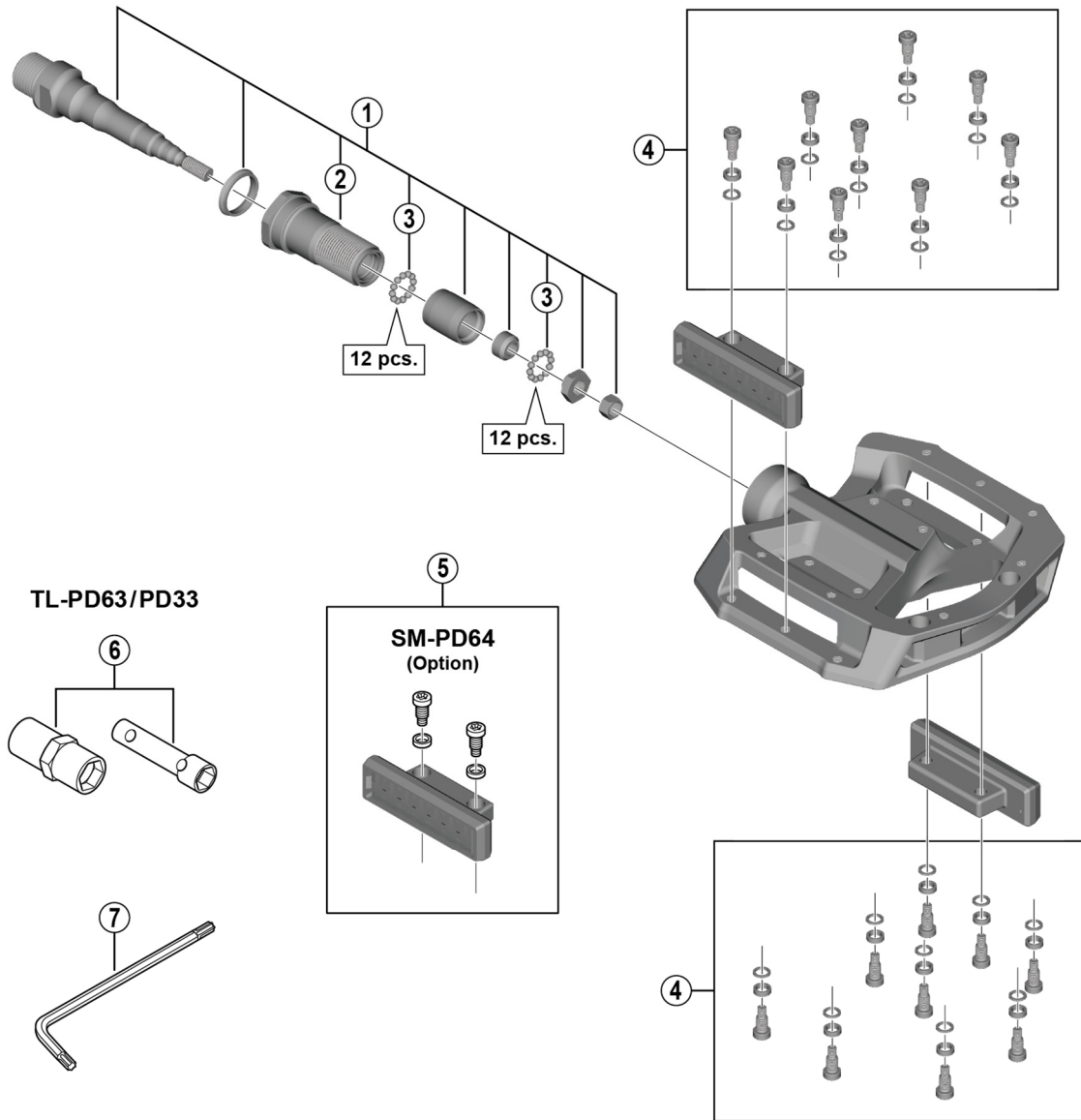

PD-MX80

ITEM NO.	SHIMANO CODE NO.	DESCRIPTION	INTERCHANGEABILITY
1	YL8798020	Pedal Axle Assembly (Right / B.C.9/16" x 20T.P.I.)	B
	YL8798030	Pedal Axle Assembly (Left / B.C.9/16" x 20T.P.I.)	B
2	YL8798040	Lock Bolt (Right)	B
	YL8798050	Lock Bolt (Left)	B
3	Y41N98030	Steel Ball (3/32") 62 pcs.	A
4	YL8798010	Pin & Spacer (9 pcs.)	B
5	Y46R98060	SM-PD64 Reflector Unit (4 pcs. / Option)	A
	Y46R98070	SM-PD64 Reflector Unit (AS / 4 pcs. / Option)	A
6	Y46098630	TL-PD63 Cone Adjusting Tool Set	A
	Y41N98040	TL-PD33 Cone Adjusting Tool Set	A
7	Y46R10000	Hexalobular Socket Screw Key	A

A: Same parts.

B: Parts are usable, but differ in materials, appearance, finish, size, etc.

Absence of mark indicates non-interchangeability.

Specifications are subject to change without notice.

Jul.-2017-4223

© Shimano Inc. I

SHIMANO